

**THE ULTIMATE**

*Investment Destination*



**A PREMIUM VILLA OPEN PLOTS PROJECT**

T.L.P. NO. 162/2023/H



[www.adhirangroup.com](http://www.adhirangroup.com)



**COMMERCIAL PLOT - 14,000/- PER SQ. YD.**

**ADDITIONAL CHARGES FOR SPECIFIC PLOTS**

- > North East Corner : ₹300/- per Sq. Yd.
- > Any Corner Plot : ₹250/- per Sq. Yd.
- > East Facing Plot : ₹200/- per Sq. Yd.
- > 40 Feet Road Facing : ₹200/- per Sq. Yd.



T.L.P. NO/162/2023/H

(NOT TO SCALE)

# PROJECT HIGHLIGHTS:



Entrance Arch



DTCP Approved Layout designed as per Vastu



40, and 33 Feet Blacktop Roads



Gated Community with Avenue Plantation



Electric Poles with Street Lighting



Parks and Open Spaces

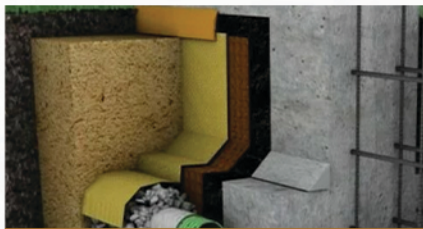

Underground Drainage System



Clear Title

# LOCATION HIGHLIGHTS:



Near Upcoming Future City (The 4th City of Hyderabad)



5 Minutes Drive to Amazon Data Center



Surrounded by upcoming Pharma Clusters



Near Upcoming Young India Skill University



Close to Upcoming Health Hub (spanning 1000 acres)



Near Upcoming Sports University & Cricket Stadium

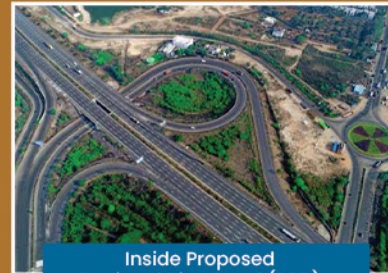

Inside Proposed Regional Ring Road (RRR)



30 Minutes Drive to BDL, NSG, Octopus at Ibrahimpatnam



Access to 20 Engineering Colleges & 40 PG Colleges



20 Minutes to TATA Aerospace SEZ, Yelimedu

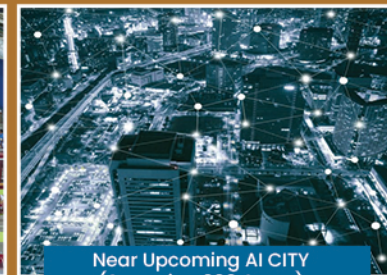

Near Upcoming AI CITY (Spanning 200 Acres)



Approved 4 way Track on Nagarjuna Sagar Highway

# LOCATION MAP

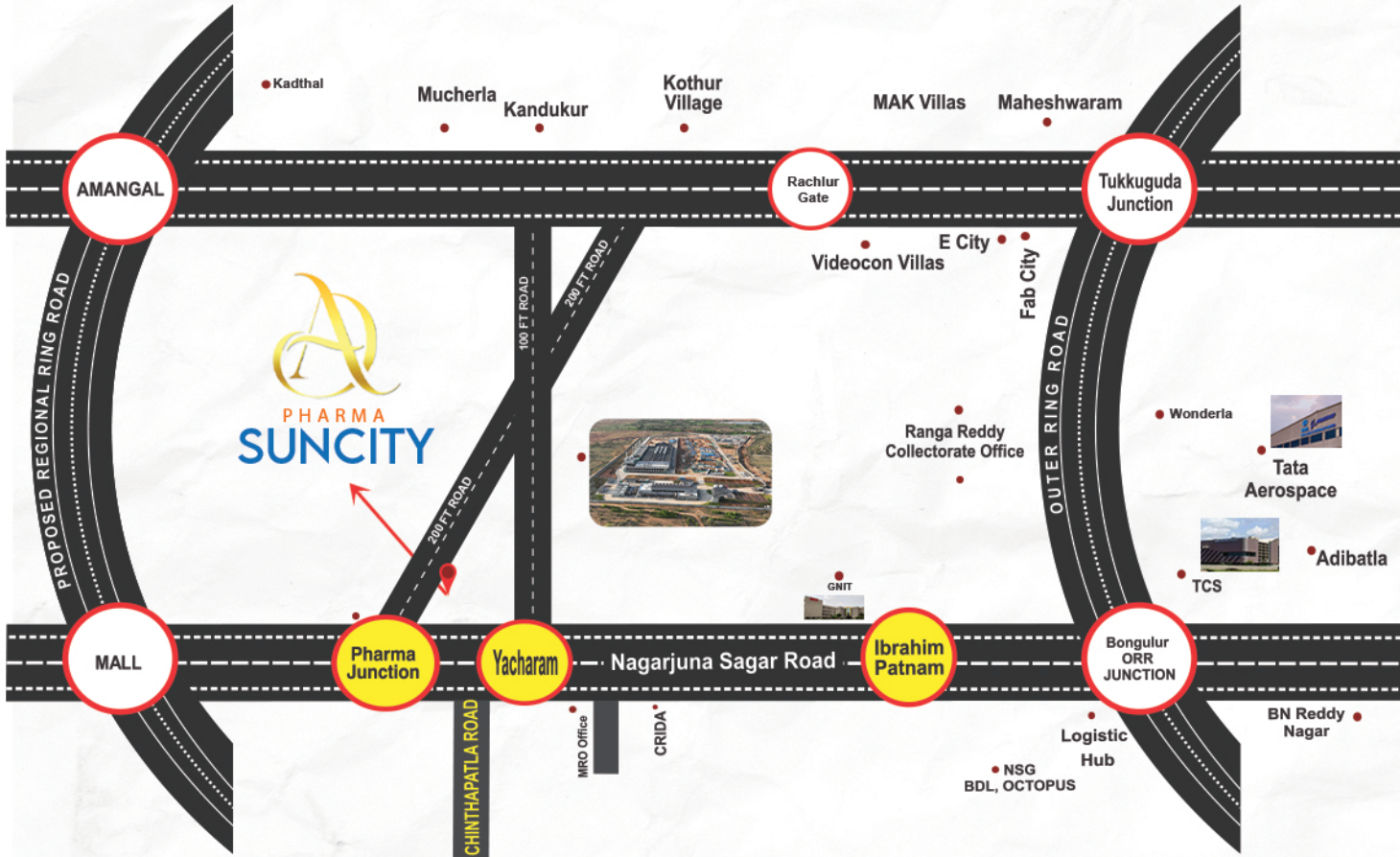

**OFFICE ADDRESS :**  
 BHAGAYATH FACE 2, NAGOLE RD, NEAR SHILPARAMAM,  
 LAXMI NARAYAN NAGAR COLONY, UPPAL, HYDERABAD,  
 TELANGANA 500039

**FOR MORE DETAILS CONTACT :**